

PRO PLUG SYSTEM®

Wood

Hidden Fastener for Wood Decking and Flooring



APPLICATION

Hidden fastening system that provides a secure face-fastened connection with precision cut, face grain plugs made from a variety of hardwood decking and flooring. Installation is a four step process utilizing a predrilling tool, glue (sold separately), screw and plug.

FEATURES

- Provides the strength of top-down fastening with the high end finish of face grain wood plugs
- Drill, screw, glue and plug all types of hardwoods in a fraction of the time compared to traditional plug methods
- Patented Wood Tool creates a screw hole, countersink and counterbore to match other system components
- Free spinning stop collar on Wood Tool prevents damage to the board surface
- Patented glue nozzle applies glue to the sidewall of the counterbored hole
- Kit packaging includes screws, plugs and glue nozzle (Wood Tool sold separately)

INSTALLATION

Follow all decking and flooring manufacturer instructions, including specifications for screw spacing, edge/end distances, and gapping.

- Predrill with the countersinking Wood Tool using a corded drill on high speed until the collar stops spinning. Remove debris from hole.
- Drive screw so that it is fully seated in the countersink. (Do not overtighten.)
- Fit glue nozzle on glue bottle. Apply glue to hole by pushing down and gently squeezing the bottle while rotating it one quarter turn, then remove. Glue should coat the side walls of the hole.
- Insert plug into hole, align grain of plug to match grain of board, and tap with a smooth-faced hammer until the plug is flush with board.

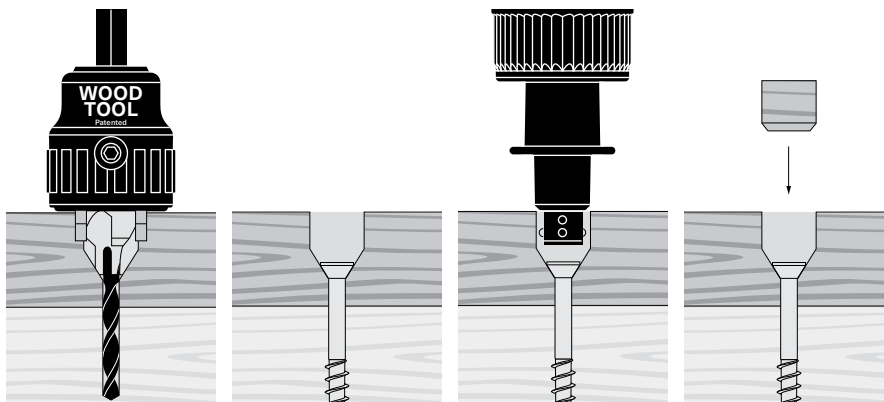

FINISH

DECKING KITS

Grade 305 Stainless
Grade 316 Stainless

FLOORING KITS

Grade 305 Stainless

CORROSION

DECKING & FLOORING KITS

Exterior use—Approved for use in ACQ and pressure treated lumber.

For salt water or other areas where corrosion is a concern, use Grade 316 Stainless.

DRIVE SYSTEM

Star drive

TOOL COMPATIBILITY

Wood Tool
Wood Tool Replacement Bits

PLUGS AVAILABLE IN THE FOLLOWING HARDWOOD DECKING

ALASKAN YELLOW CEDAR	BAMBOO	CAMBARA	CUMARU	DASSOXTR FUSED BAMBOO®
GARAPA	IPE	IRON WOODS®	JATOBA	KEBONY®
MAHOGANY	MASSARANDUBA	MERANTI	MERBAU	PEDRA
PROTEAK	RED BALAU	THERMORY®	TIGERWOOD	YELLOW BALAU

PLUGS AVAILABLE IN THE FOLLOWING HARDWOOD FLOORING

AMERICAN CHERRY	AMERICAN WALNUT	EASTERN WHITE PINE	MAHOGANY	POPLAR
RED OAK	WHITE OAK			

New board brands are always being added to our product offering. Please refer to our website or contact Starborn® customer service if you do not see the board brand you are looking to use on your project.

SYSTEM COMPONENTS

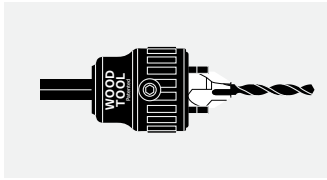

Countersinking Wood Tool
For predrilling and countersink
(Sold separately)

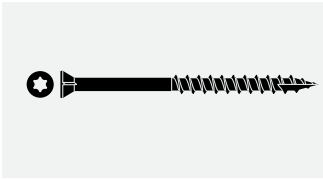

Screws
Grade 305 or Grade 316
stainless for decking, Grade
305 stainless for flooring

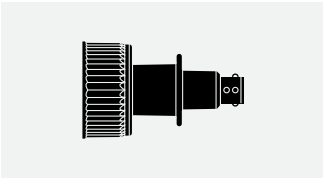

Glue Nozzle
Applies glue to sidewalls of
screw hole

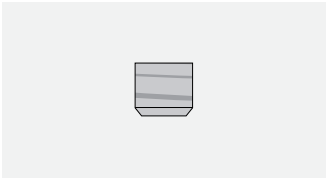

Plugs
Made from actual hardwood
species

PRO PLUG® SYSTEM WOOD PACKAGING

DECK KIT PACKAGING					
LENGTH	FINISH	COVERAGE	SCREWS	PLUGS	TOOL
1-5/8"	305 Stainless	25 sq ft	100	100	—
		100 sq ft	350	350	—
		300 sq ft	1050	1050	—
2-1/2"		25 sq ft	100	100	—
		100 sq ft	350	350	—
		300 sq ft	1050	1050	—
1-5/8"	316 Stainless	25 sq ft	100	100	—
		100 sq ft	350	350	—
		300 sq ft	1050	1050	—
2-1/2"		25 sq ft	100	100	—
		100 sq ft	350	350	—
		300 sq ft	1050	1050	—

FLOOR KIT PACKAGING					
LENGTH	FINISH	COVERAGE	SCREWS	PLUGS	TOOL
1-5/8"	305 Stainless	25 sq ft	100	100	—
		100 sq ft	350	350	—
		300 sq ft	1050	1050	—